

1 PRODUCT OVERVIEW

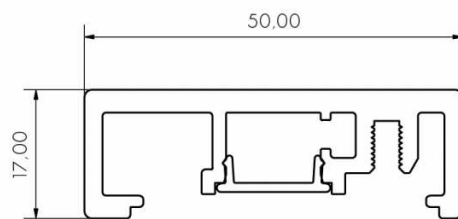

RICHIE RAIL 17

2 INSTALL WALL BRACKETS

1. IF USING PLASTERBOARD SPACERS (RECOMMENDED FOR ANY INSTALLATION ONTO PLASTERBOARD), USE A 38MMØ HOLE SAW TO DRILL HOLE THROUGH PLASTERBOARD AND REMOVE CUT-OUT TO REVEAL TIMBER FIXING BEHIND. IF SPACER IS NOT REQUIRED, GO TO STEP 3.
2. FEED LOW VOLTAGE CABLE FROM WALL INTO PLASTERBOARD SPACER AND INSERT INTO HOLE IN PLASTERBOARD.
3. FEED LOW VOLTAGE CABLE THROUGH MOUNT FLANGE AND SCREW-FIX TO WALL. ENSURE O-RING IS PROPERLY POSITIONED IN MOUNT FLANGE GROOVE.
4. PUSH COVER PLATE A SHORT WAY ONTO WALL BRACKET, THEN PUSH WALL BRACKET OVER MOUNT FLANGE. PUSH COVER PLATE OVER MOUNT FLANGE SO IT SITS TIGHT AGAINST WALL. LOCK WALL BRACKET TO MOUNT FLANGE USING THE 2X M4X5 GRUB SCREWS.
5. REPEAT STEPS FOR SOLID BRACKETS (THOSE WHICH DO NOT A POWER FEED).

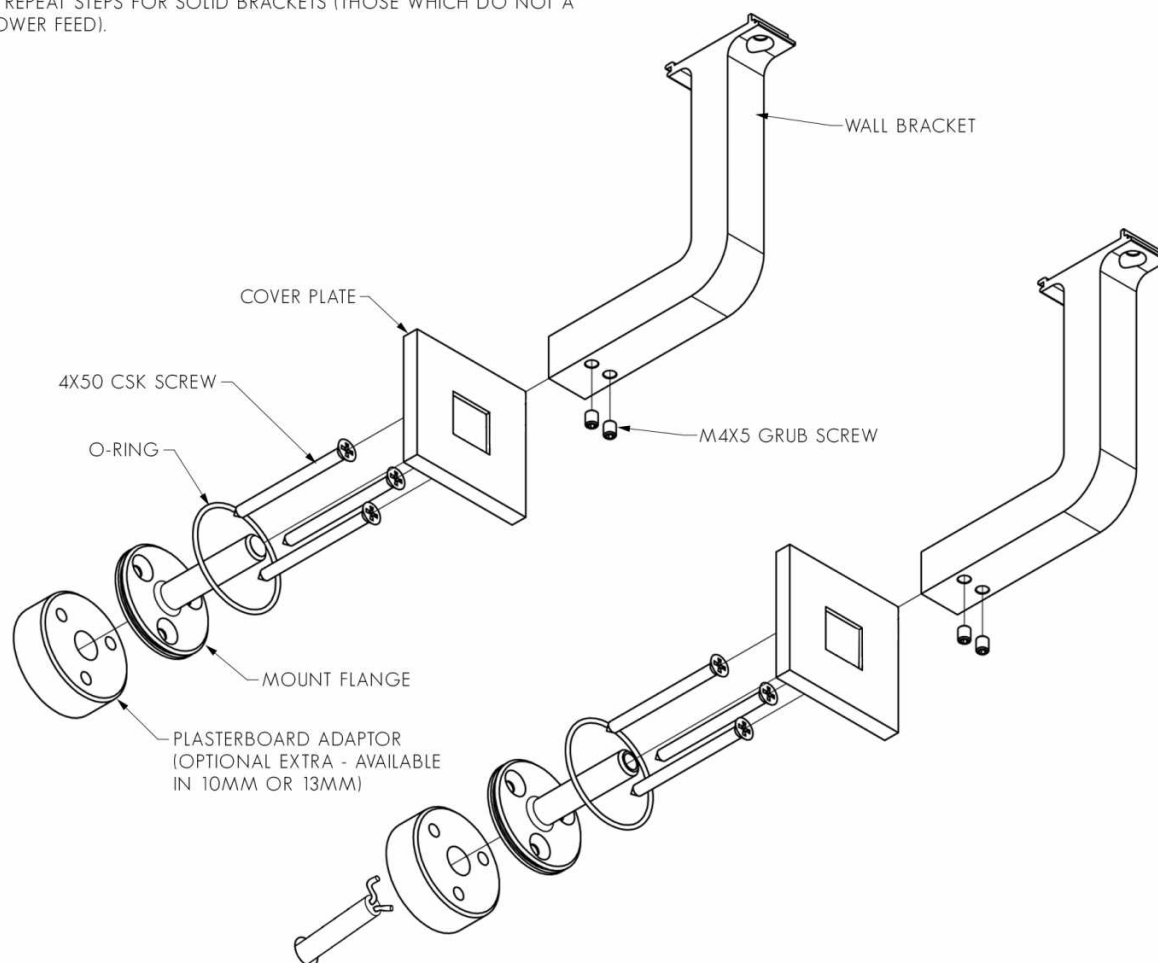

2

INSTALL JOINERS, END CAPS & LED STRIP

1. IF USING MULTIPLE LENGTHS OF EXTRUSION, SLIDE EXTRUSIONS TOGETHER ON TO JOINERS AND LOCK TOGETHER WITH GRUB SCREWS (SEE FIG. 1).
2. FEED LED STRIP CABLE THROUGH HOLE OR GAP IN DIFFUSER.
3. **IMPORTANT:** BEFORE MOUNTING LED STRIP, CLEAN EXTRUSION USING AN ALCOHOL BASED CLEANER.
4. REMOVE BACKING FROM LED STRIP TO EXPOSE STICKY SURFACE. LAY LED STRIP INTO EXTRUSION, USING THE SMALL GROOVES IN THE BACK OF THE EXTRUSION AS A GUIDE.
5. CLIP DIFFUSERS INTO EXTRUSION, ENSURING A FIRM CONNECTION (SEE FIG. 1).
6. CLIP ALUMINIUM LIDS INTO PLACES (IF USING).
7. PUSH END CAPS INTO EXTRUSION AND LOCK INTO PLACE USING M4X8 CSK SCREWS.

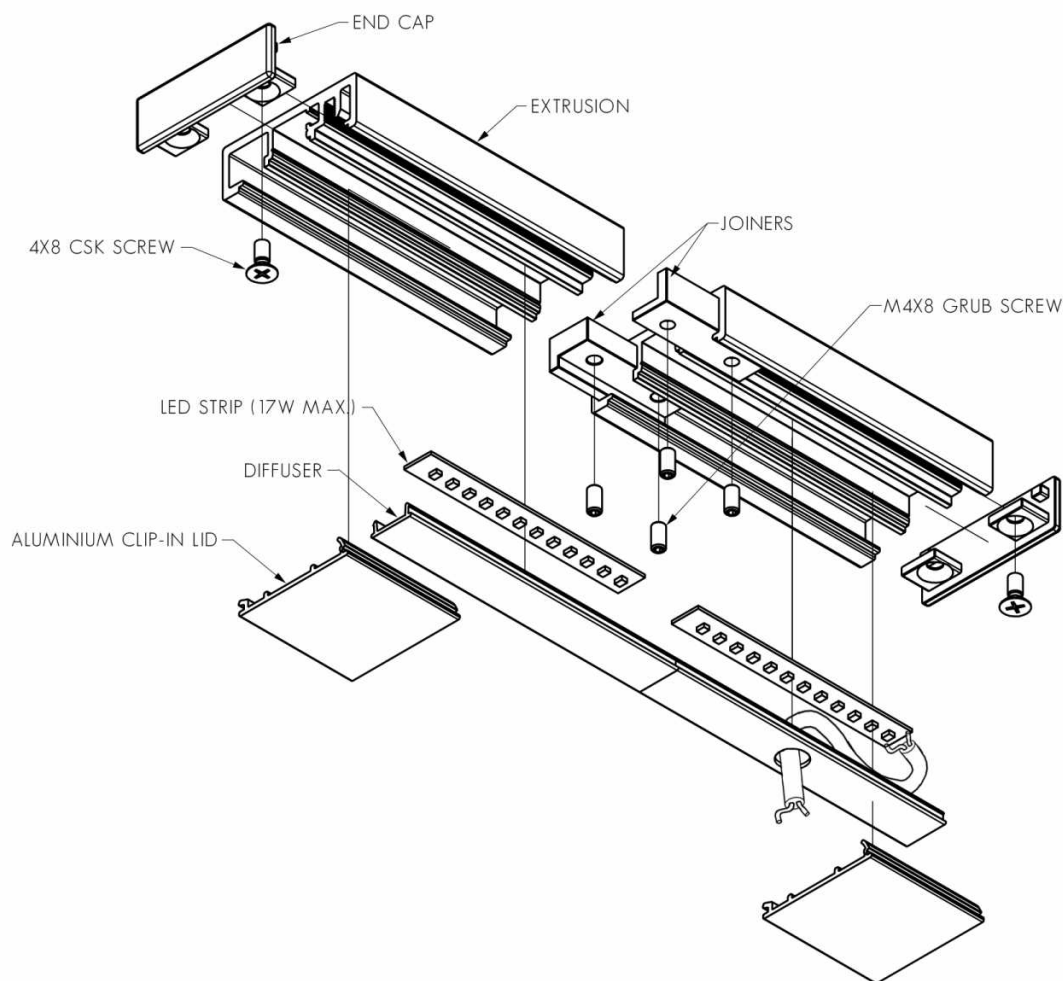

FIG. 1 - ENSURE JOINERS ARE LOCKED TOGETHER TIGHTLY

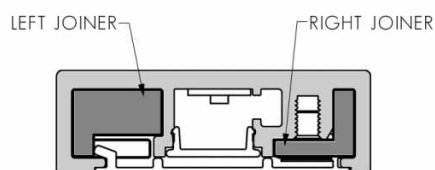
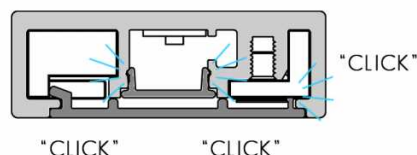

FIG. 2 - ENSURE DIFFUSER & LID ARE MOUNTED SECURELY



3 INSTALL EXTRUSION ON TO WALL BRACKETS

1. MAKE ELECTRICAL CONNECTION - SOLDER AND SHRINK LOW VOLTAGE CABLES TOGETHER AND PUSH INTO WALL BRACKET.
2. AFFIX RICHIE RAIL 17 EXTRUSION TO WALL BRACKETS USING M4X12 CSK SCREWS PROVIDED. ENSURE THEY ARE TIGHT. SEE FIG. 3.

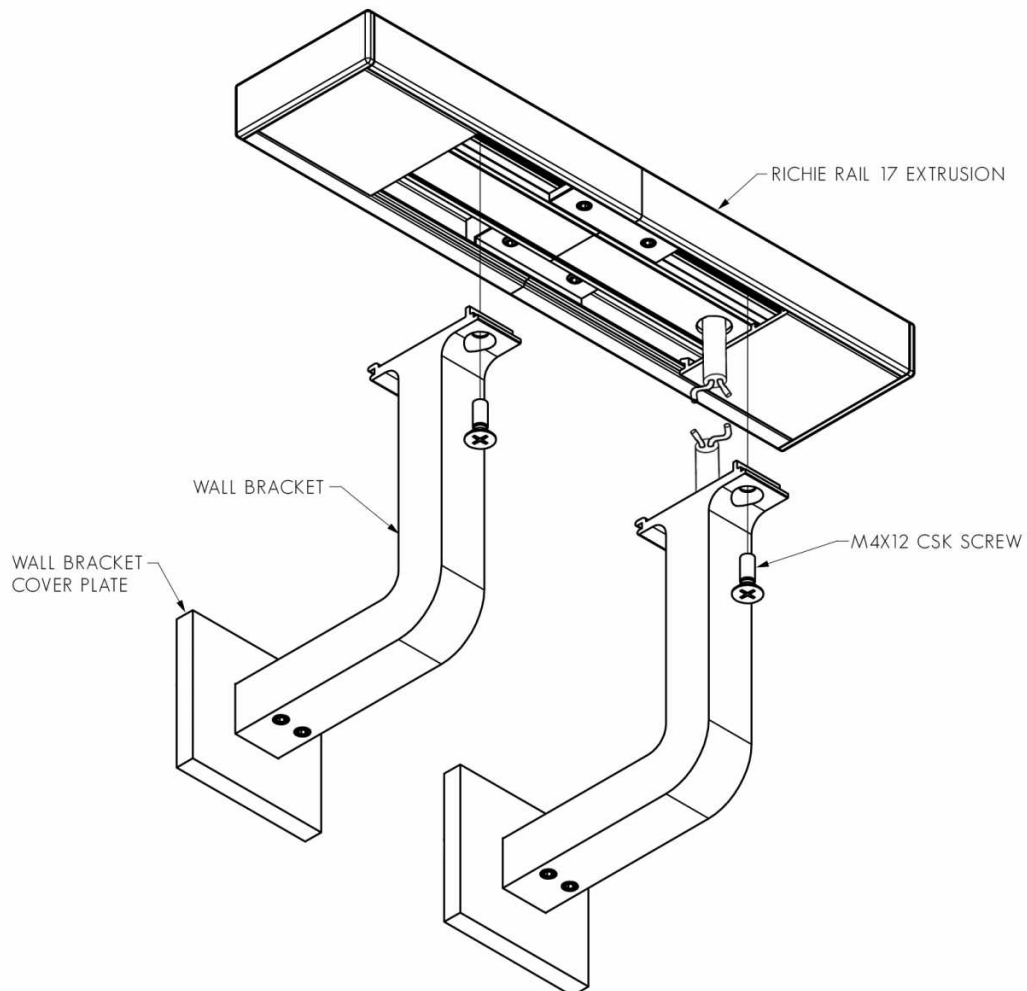

FIG. 3 - ENSURE WALL BRACKETS ARE SECURED TIGHTLY

